

Hall C

Hall B SOUTH

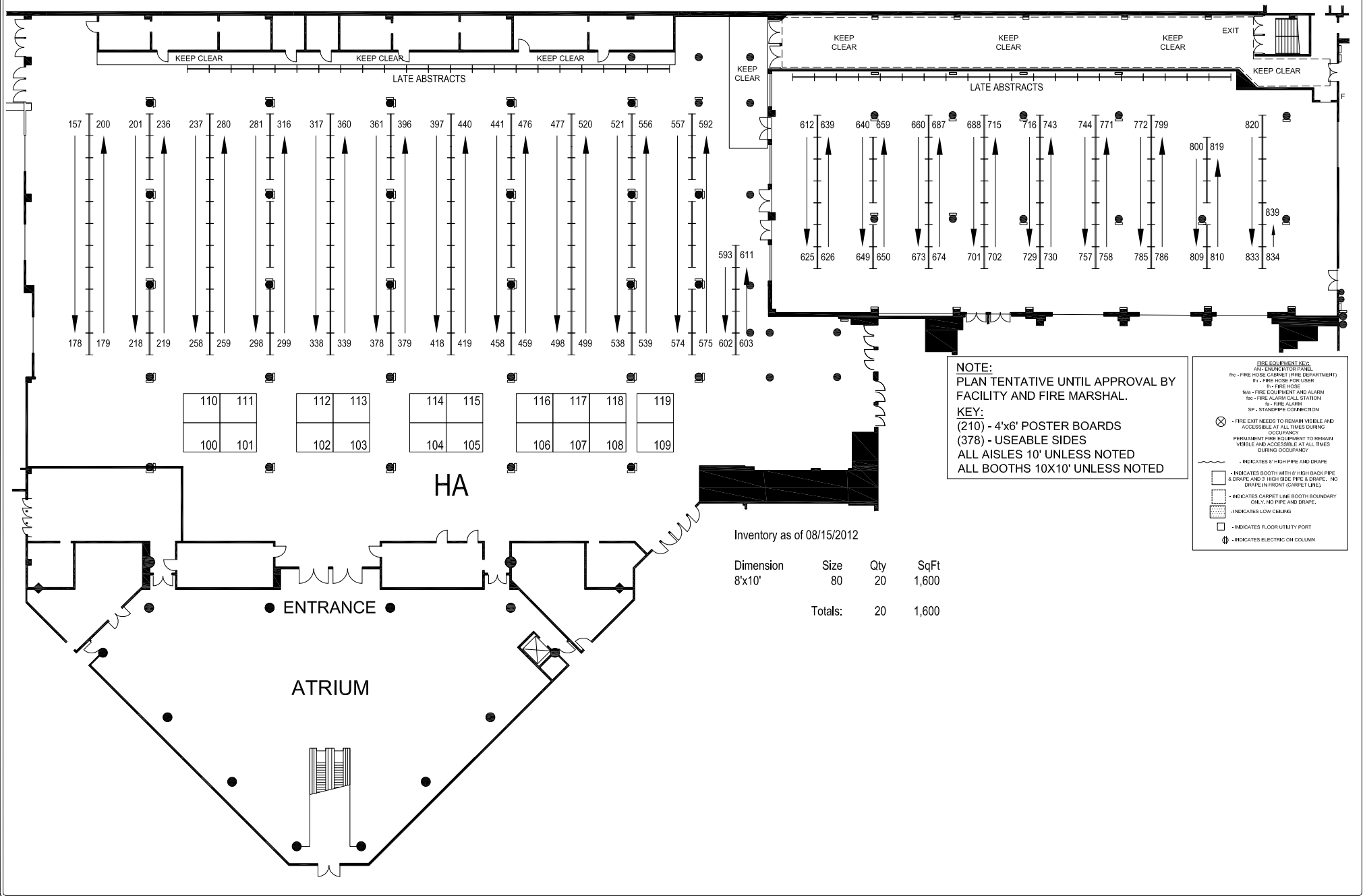

**NOTE:**  
 PLAN TENTATIVE UNTIL APPROVAL BY FACILITY AND FIRE MARSHAL.

**KEY:**  
 (210) - 4'x6' POSTER BOARDS  
 (378) - USEABLE SIDES  
 ALL AISLES 10' UNLESS NOTED  
 ALL BOOTHS 10X10' UNLESS NOTED

- ⊞ FIRE EQUIPMENT KEY:  
 APC - EXERCISER PANEL  
 FC - FIRE HOSE CABINET (FIRE DEPARTMENT)  
 FU - FIRE HOSE FOR USER  
 H - FIRE HOSE  
 HA - FIRE EQUIPMENT AND ALARM  
 SC - FIRE ALARM CALL STATION  
 SA - FIRE ALARM  
 SP - STANDPIPE CONNECTION
- ⊗ FIRE EXIT NEEDS TO REMAIN VISIBLE AND ACCESSIBLE AT ALL TIMES DURING OCCUPANCY  
 PERMANENT FIRE EQUIPMENT TO REMAIN VISIBLE AND ACCESSIBLE AT ALL TIMES DURING OCCUPANCY
- ~ - INDICATES 8" HIGH PIPE AND DRAPE
- - INDICATES BOOTH WITH 8" HIGH BACK PIPE & DRAPE AND 2" HIGH SIDE FIRE & DRAPE. NO DRAPE IN FRONT (CARPET LINE).
- ▨ - INDICATES CARPET LINE BOOTH BOUNDARY ONLY. NO PIPE AND DRAPE.
- ▤ - INDICATES LOW CEILING
- - INDICATES FLOOR UTILITY PORT
- ⊕ - INDICATES ELECTRIC ON COLUMN

Inventory as of 08/15/2012

Dimension	Size	Qty	SqFt
8'x10'	80	20	1,600
<b>Totals:</b>		<b>20</b>	<b>1,600</b>



**DROSOPHILA RESEARCH CONFERENCE**  
**MARRIOTT WARDMAN PARK HOTEL**  
**HALLS C AND B-SOUTH**  
**WASHINGTON, D.C.**  
**APRIL 3-7, 2013**

CONFIDENTIAL PROPERTY OF GES  
 File: GSA-1304-marwrd.dwg  
 Plotted: Sep 05, 2012  
 By: BECKJ  
 EVERY EFFORT HAS BEEN MADE TO INSURE THE ACCURACY OF ALL INFORMATION CONTAINED ON THIS FLOOR PLAN. HOWEVER, NO WARRANTIES, EITHER EXPRESSED OR IMPLIED, ARE MADE WITH RESPECT TO THIS FLOOR PLAN. IF THE LOCATION OF BUILDING COLUMNS, UTILITIES, OR OTHER ARCHITECTURAL COMPONENTS OF THE FACILITY IS A CONSIDERATION IN THE CONSTRUCTION OR USAGE OF AN EXHIBIT, IT IS THE SOLE RESPONSIBILITY OF THE EXHIBITOR TO PHYSICALLY INSPECT THE FACILITY TO VERIFY ALL DIMENSIONS AND LOCATIONS.